

CHT-763

RECESSED LONG WOOD GRAIN PANEL STEEL INSULATED DOOR

SERIES FEATURES

- 1 3/4" (44.5mm) - Thick CFC-Free Polyurethane
- 16.18 Calculated R-Value
- .062 Calculated U-Value
- 26-Gauge Galvanized Steel
- Full Thermal Break
- Available with Wind Load
- 21 Color Options
- Industry Leading Warranty
- 10-Year Rust & Delamination
- 6-Year Hardware
- 3-Year Spring

Cross Section

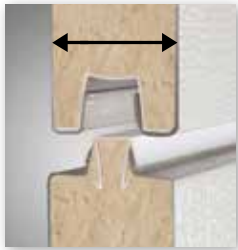

**1 3/4" (44.5mm)
Thick Sections**

AVAILABLE COLORS



Colors are not exact due to the differences in monitor and printer calibrations. For accurate color samples, contact Haas Door for a metal color selector. Trinar® colors carry a 35 year paint warranty.

MODEL FEATURES

- Extruded End Cap
- Recessed Long Panel wood grain embossment on outside, V-Groove pattern wood grain embossment inside
- Tongue and groove section joint

Exterior View

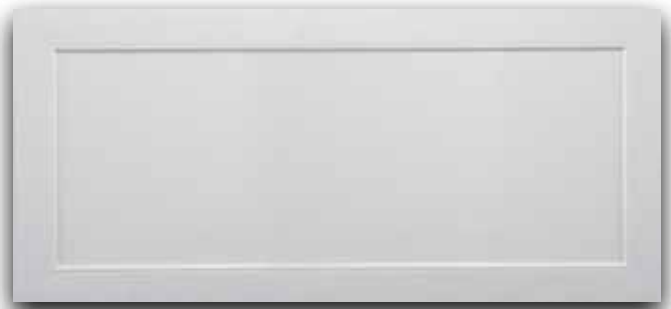

Interior View



700 SERIES LINKS

Click links for info.

HOMEPAGE

BIM

BROCHURE

SPECS

GALLERY

SPECWIZARD

CAD

CATALOG

Rev. 2.1 – October 2017